

Dear Castle Rock Public Art Commission,

Mary Williams and John King would like to submit a proposal as a team. When we learned of this opportunity we were excited to submit as we have successfully integrated relevant artworks in similar recreational spaces in unique and memorable ways. You'll find in our proposal examples of sculptures that we have collaborated on together and other pieces that we believe are excellent examples of what we would like to propose for the Philip S. Miller Park.

Our vision is to create a signature artwork relevant to your site that engages your audiences and creates an overall lasting image for the park. With all the active amenities such as: The Mac, The Challenge Hill, Zip Line, and the The Epic Adventure Tower to name just a few, the park is action packed and full of motion. Which is why we thought that a static sculpture, while potentially interesting, just wasn't enough to live up to this energetic park! Thus we turn to the world of kinetic sculptures.

We would like to submit two ideas that have kinetic executions. Sculptures that create motion seemed like a perfect fit to embrace the essence of the park. Our first concept we call "Tree of Light" resembles a tree with branches and leaves circling overhead in the wind. The leaf shapes have holes within them that would cast dancing shadows on the ground. We envision children dodging the shadows like a game. Our second concept " Exercisers" has three sculptures graceful moving around each other as if they were participating in an exercise routine. Brightly painted they will surely be seen from a distance and welcome visitors to park. These sculptures would beg for photos, as viewers are likely to mimic the movements of the sculptures for the camera.

The sketches attached show both concepts in recommended potential locations. Colors are yet to be determined. " Tree of Lights" would be approximately 14'tall x 10' wx 10'd. Weighing 600lbs. Placed on a 6' – 8' diameter slab on grade 8" – 12" thick. The "Exercisers" would be approximately 17' tall x 14'wide x 14' d for all three. Weight per sculpture 200lbs. placed in individual postholes 14" diameter by 3' deep. Both concepts can be created within the \$50,000 budget. Itemized breakout of cost will be provided if one of these concepts is chosen for the semi-finalist round.

John and Mary have a combined 25 years of experience working within the field of public art. They are experienced in effectively communicating concepts and enjoy the spirited creative process of working on a team. We would approach your project using various time-tested materials that are commonly used for outdoor structures.

We believe collaboration is about shared visions driven by powerful ideas. A successful project is one that ensures that the vision and ideas are protected throughout and that the final outcome is one that is not a surprise, but spot on! We are available for your timeline and are excited to create a signature kinetic sculpture for the Philip S. Miller Park.

Sincerely, Mary Williams and John King

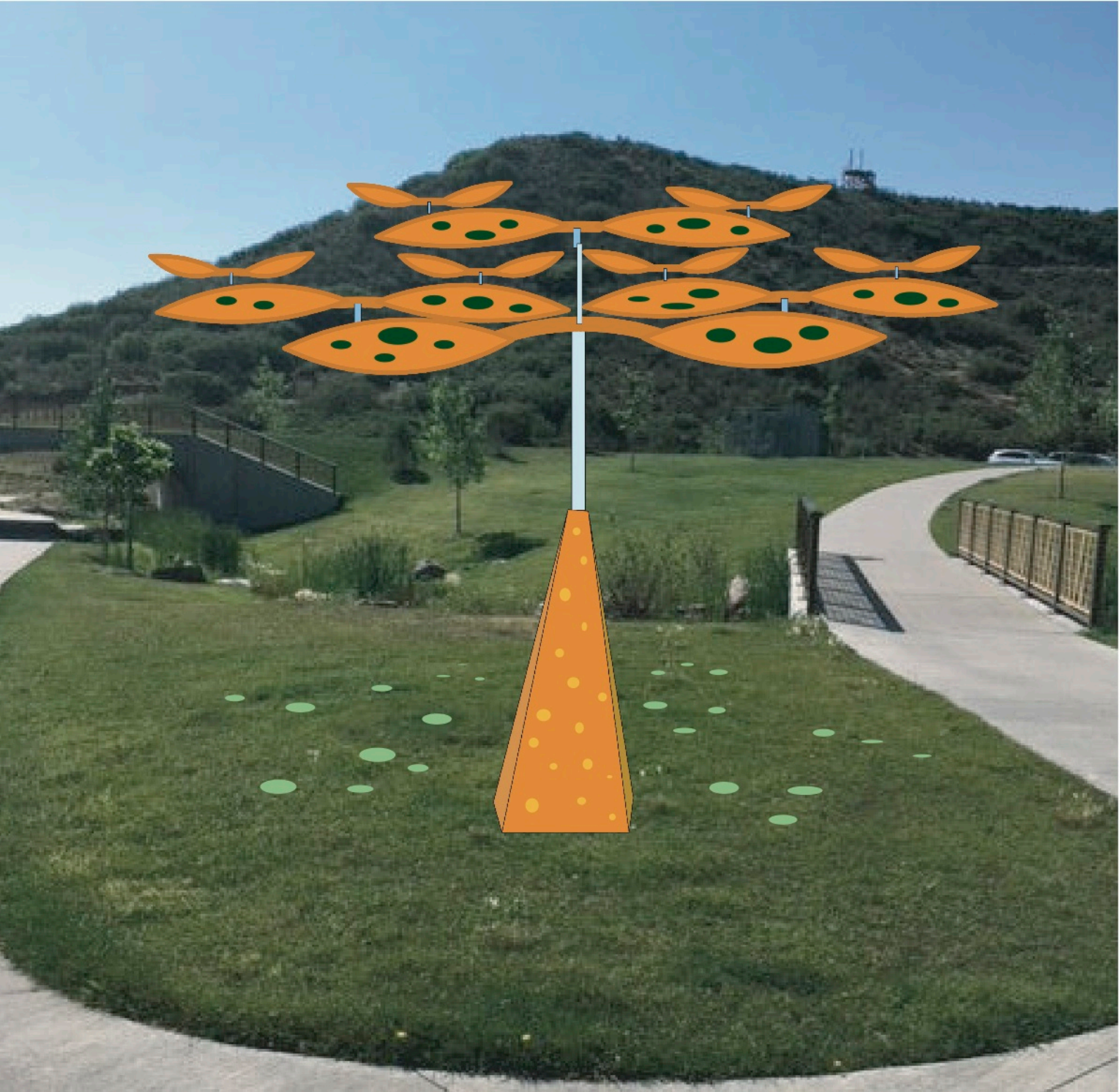

8/26/18

**Castle Rock Public Art commission request for budget
Philip S. Miller Park sculpture**

Artist team - Mary Williams/John King

Tree of Lights

Artist Design Fee	\$4,250
Consultation Fees	\$800
Working Drawings	\$2,000
Materials and Supplies	\$9,000
Fabrication	\$21,000
Assembly & Balance	\$750
Foundation Excavation	\$300
Permits	\$100
Lighting Budget	\$5,500
Creation of Foundation	\$1,500
Delivery of Artwork	\$300
Installation	\$ 1,000
Administrative Expenses	\$500
Travel	\$250
Photography for Documentation	\$250
Contingency	\$2,500
Total Budget	\$50,000

Please send any questions to:

Mary Williams 303-570-9435 mwadart@comcast.net

John King 303-204-2662 john1king2@msn.com



8/26/18

**Castle Rock Public Art commission request for budget
Philip S. Miller Park sculpture**

Artist team - Mary Williams/John King

Playmates - 3 sculptures

Artist Design Fee	\$6,000
Consultation Fees	\$800
Working Drawings	\$3,600
Materials and Supplies	\$9,000
Fabrication	\$22,000
Assembly & Balance	\$750
Foundation Excavation	\$400
Creation of Foundation	\$1,500
Delivery of Artwork	\$300
Lift	\$500
Installation	\$1,200
Administrative Expenses	\$500
Travel	\$200
Photography for Documentation	\$250
Contingency	\$3,000
Total Budget	\$50,000

Please send any questions to:

Mary Williams 303-570-9435 mwadart@comcast.net

John King 303-204-2662 john1king2@msn.com

Resume - John King [See videos of my Kinetic and Interactive Art.](https://www.johnkingarts.com/sculptures/)

<https://www.johnkingarts.com/sculptures/>

In Development:

2018 July. Developing an entry sculpture for the new Boulder Community Hospital Building in Boulder.

2018 July. Building the "Strange Birds" piece in the studio.

2018 June. Applied for the Denver Museum of Nature and Science Commission "Run for Cover"- on Being a mammal in the late Cretaceous Period

2018 May. Chosen for the Aurora Murphy Creek Firehouse Commission. "First Response"

2018 Feb. Chosen for the University of Michigan Commission for entry kinetic artwork for the new Biological Sciences Building. \$200,000. "Biological Tree of Life"

.

Recent Work:

2018 May. Installed 2 new artworks in the new Bison Ridge Rec Center, Commerce City, CO. A large lobby interactive overhead piece "Happiness Runs" and three turning wall interactive wheels, "Spinning".

2018 May. Exhibiting "Tangerine Glider and "Sky Writing 1" at the Overland Park Arboretum, Kansas. National Kinetic Art show "Whirlwind-Art in Motion"

2017 Oct. Installed "Butterfly Tree" at the Broomfield Health Department.

2017 Sept. Completed an interactive entry lobby sculpture for the Bemis Public Library, Littleton.

2017 July. Completed an outdoor interactive sculpture for a donor funded commission for Children's Hospital in Denver

2017 May. Installed "Lollipop Tree" for the City of Greeley Uptown Tree Project.

2017 Feb. Installed "Sunrise" at RTD Aurora Station on the light rail system. 18' round interactive sun. \$175,000 total commission.

2016 Dec. Installed 3 large outdoor thematically linked kinetic sculptures in Rotella Park in Adams County CO. "Cloud Castles, Sky Writing, and Sun, Moon, Stars Windvane." All on the theme of "Look Up".

2016 Sept. Exhibiting "Yin/Yang II" at International Kinetic Art Show in Boynton Beach, FL.

2016 August Completed \$255,000 total commission for the Denver Public Schools. 3 Lobby interactive sculptures and a main entry wind activated Sculpture at the Emily Griffith Campus – at Lincoln St. and 18th St. Denver.

2016 August Installed the "Silver Butterfly Tree" park piece purchased by the City of Northglenn CO.

2016 August Installed 3 new works-"Balance in Motion" exterior piece at the new Broomfield Health and Human Services Department building and "Moving Center" a signature lobby installation, and "Heart Wall" in the Main Hallway.

2016 April Installed the Littleton Golf and Tennis Club Sculpture "Movement from Balance".

2015 April Exhibited "Yin/Yang I" At Evergreen CO. Sculpture Show.

2014 Nov. Installation of 2 children's interactive wall pieces in Kaiser Permanente at Rock Creek Facility. "Kaleidoscope and Butterfly Tree" in children's waiting area.

2014 Sept. Exhibited "Blue Butterfly tree II" at the International Kinetic Art Show in Boynton Beach, Fla.

2014 Sept. Installed "Lotus Dragon" in Torii Square Park in Westminster, CO. A towering dancing dragon in silver, red, raspberry and plum colors.

2014 August. Installed "Orchard Sprite" a 22' tall dancing apple tree in Orchard Town Center Development in Westminster, CO. in the Arbor Commons Park.

2014 August. Exhibited "Butterfly Tree 1" sculpture in E.B.Rains park in Northglenn, CO wins the "Peoples Choice" Award and is chosen for purchase.

2014 June. Completed the Grand Stairway Interactive Art at Lonetree Medical Center. 80' tall sculpture consisting of 5 interactive murals in Grand Stairway.

2014 April. The commission for the Butterfly Pavilion "Chasing Light" entry sculpture is completed and installed.

2013 Dec. The first section of the restored Kaiser Lonetree Stairway artwork is saved from the flood and is reconditioned and installed for the building opening in early December. The other 4 sculpture sections were lost in the flood. Kaiser recommissions the work and art is being created in the newly constructed studio on Apple Valley Rd.

2013 September 12th. *The North Saint River in Lyons floods after 4 days of continuous rain.* The artist's studio is swept into the raging river. The bridge across the river is lost. Large portions of the main house are destroyed and damaged. Recovery begins immediately.

2012 Oct. Exhibition of "Palm Dancer" and "Tangerine Glider" in the 2012 International Kinetic Art Show in Boynton Beach, Florida.

2012 July. Installation of "Rising Dancer1" at the Buell Children's Museum- Sangre de Cristo Arts and Convention Center, Pueblo, CO.

2012 June. Purchase of "Green Glider" for City Park in Greeley, CO.

2011 October. Purchase of "Dragonfly/Giraffe 2 by the City of Greeley, CO. for display in the downtown area.

2011 July. One year display of "Silver Glider" in Westminster Art on 73rd St. Show.

2011 January. Chosen as the winner in a national commission to create an entry sculpture for Pueblo's Sangre de Cristo Arts and Convention Center.

2010 November. Purchase of "Green Snap Dragon 2" by the City of Grand Junction, CO for display at the East end of Main St, Old Downtown. Winner of "Peoples' Choice".

2010 Sept. Installation of "Snap Dragon" in Cornerstone Park, Centennial, CO. a large public art piece in the center of the traffic circle entrance. 20' high and 25' wide.

2010 Feb. "Dragonfly/Giraffe 1. Purchased by the Boulder Public Library and displayed in front of the "Canyon Gallery".

2009 Purchase and installation of 18' tall kinetic sculpture "Dragonfly/Giraffe 1" for in front of the Boulder Public Library, Boulder, Colorado.

2009 Purchase and installation of kinetic sculpture "Sunflower/Dragonfly 1" for permanent display by the City of Aurora, CO at Hampden Run Park.

2007 Flying kinetic piece "Community Garden Dragonfly" purchased and installed in the Goss Grove Community Gardens in Boulder, Colorado.

2007 Hanging Stone Sculpture "Forest Heart" purchased for permanent display at the Naropa University main campus gardens, Boulder, Colorado.

2006 One year display of "Gateway Dancer" selected for the inaugural Gateway to the Town of Lyons outdoor sculpture exhibition.

2005 Recipient of the Addison Mini Grant for emerging artists.

1975-2005 John was a general contractor / design and construction of custom homes in CO.

1966-1970 Attended Beloit College in Beloit, Wisconsin. Major in Fine Arts.

Mary Williams Art Resume

7205 Middleham Place Castle Rock, CO 80108

303-570-9435

www.MaryWilliamsArt.com mwadart@comcast.net

Public Art Commissions

- 2018 Littleton Adventist Hospital, Littleton, CO - Tall Pole Totems
- 2017 Castle Rock Adventist Hospital, Castle Rock, CO - Hibiscus Sculpture
- 2017 Parker Adventist Hospital, Parker, CO - Memorial Candles
- 2015 Eaglecrest Ski Resort, Porcupine Learning Center, Juneau, AK - Ski Snowflakes
- 2014 Buttermilk Ski Resort, Aspen, CO - Ski School Totems
- 2011 Kaiser Permanente Denver, CO - Layered Lines
- 2011 Elk Ridge Park, City of Castle Pines North, CO - Solstice Sculptures
- 2010 Department of Revenue Complex, Tallahassee, FL - Waterweave
- 2008 Florida State University, Tallahassee, FL - Waterweave Quilt
- 2008 Schoenbar Middle School, Ketchikan, AK - Haning Totems
- 2007 Denver's Children's Hospital, Aurora, CO - Buttons and Button Quilt
- 2005 Vail Associates - Beaver Creek Kids Ski School, Avon, CO - Kids Ski School Totems
- 2004 Kaiser Permanente Ken Caryl Medical Office, Littleton, CO - Aspens in Motion
- 2003 The Phillip S. Miller Library, Castle Rock, CO - "Bob"

Commercial Commissions/Sales

- 2016 Colorado Bureau of Investigation Crime Lab, Denver, CO
- 2015 Clayton Oaks Living, Assited Living and Memory Care, Richmond, TX
- 2013 Canyon View Medical Office Building, Grand Junction, CO
- 2013 Castle Rock Adventist Hospital, Castle Rock, CO
- 2012 Children's Hospital, Denver, CO
- 2011 Parker Adventist Hospital, Parker, CO
- 2011 Jackson National Life Insurance, Nashville, TN
- 2011 Kaiser Permanente Franklin Building, Denver, CO
- 2010 Rocky Mountain Children's Hospital, Denver, CO
- 2010 St. John's Hospital, Denver, CO
- 2009 Aurora History Museum, Aurora, CO
- 2009 Wildhorse Alpine Club, Steamboat Springs, CO
- 2009 St. Mary's Hospital, Grand Junction, CO
- 2009 North Colorado Medical Center, Greeley, CO
- 2008 DCP Midstream, Denver, CO
- 2008 Hyatt Studios, Denver, CO
- 2007 Equity West, Denver, CO
- 2007 McKee Medical Center, Loveland, CO
- 2007 Platte Valley Medical Center, Brighton, CO
- 2007 Union Terrace, Lakewood, CO
- 2007 Vail Plaza Hotel, Vail, CO
- 2007 Jackson National Life Insurance, Denver, CO
- 2006 North Colorado Medical Center in Greeley, CO
- 2006 Beaver Run Resort - Breckenridge, CO
- 2006 Mark West Energy - Denver, CO
- 2005 McKee Medical Center in Loveland, CO
- 2005 Easy Entrees - Lakewood, CO
- 2004 Kaiser Permanente Westminster Medical Office, Westminster, CO
- 2004 Kaiser Permanente Rock Creek Medical Center, Broomfield, CO

Mary Williams Art Resume pg.2

Exhibitions

- 2017 Media Mixed Exhibit, Expand Group, Colorado Fine Arts Gallery, Arapahoe Community College, CO
- 2016 Experimental Exhibit, Expand Group, The Art Gym, Denver, CO
- 2015 Running Dialogue Exhibit, Expand Group, Lone Tree Art Center, Lone Tree, CO
- 2015 From Here to There, Expand Group Exhibit, ABuzz Gallery, Denver, CO
- 2014 From Here to There, Expand Group Exhibit, Denver International Airport
- 2013 To Expand, Teal Art Gallery, Breckenridge, CO
- 2013 To Expand Artist, Denver Athletic Club, Denver, CO
- 2012 To Expand Exhibition, The Madden Museum of Art, Greenwood Village, CO
- 2012 Aspen Contemporary, solo show, Teal Art Gallery, Breckenridge, CO
- 2012 Sculptural Dimension, Republic Plaza, Denver, CO
- 2012 This is Colorado Show, Madden Museum, 1st. Place Award, Greenwood Village, CO
- 2011 Lone Tree Fine Art Exhibit, Lone Tree, CO
- 2011 Risk and Reward Show, Studio 12 Gallery, Denver, CO
- 2010 Poems of the High Desert, Lumina Gallery, Taos, NM
- 2010 Curtis Arts & Humanities Center, All Colorado Art Show 2010, Greenwood Village, CO
- 2009 The Small Works Show, Square Deal Gallery, Denver, CO
- 2009 Enso the Circle, group show, Space Gallery, Denver, CO
- 2009 Enso the Circle, group show, The Dairy Center for the Arts, Boulder, CO
- 2008 The Enso Gallery solo show, Denver, CO
- 2008 Spark Gallery supporting member show, Denver, CO
- 2008 2008 Denver International Airport Art Program exhibit Colorado, Denver, CO
- 2008 Aurora East End Arts District- Sculpture on the Fax, Aurora, CO
- 2007 The Denver Modernism Show, Denver, CO
- 2006 The Spring Exhibit, The Philip S. Miller Library, Castle Rock, CO
- 2005 Buell Theater, Denver, CO
- 2005 Colorado Art Open, Foothills Art Center, Golden, CO
- 2004 2004 Fall Art Harvest, group show, Denver, CO
- 2004 Republic Plaza Outdoor Art Festival, Denver, CO
- 2004 Volunteers for Outdoor Colorado Solo Exhibit, Denver, CO
- 2003 Foothills Art Center, Colorado Art Open, Golden, CO
- 2002 Curtis Arts & Humanities Center, All Colorado Art Show 2002, Greenwood Village, CO
- 2002 Spark Gallery, juried group show, Denver, CO
- 2002 Core Gallery, Wide Open Whatever juried group show, Denver, CO
- 2001 The Joseph Thayer Gallery, group show, Castle Rock, CO

Bibliography

- 2013 Via Magazine.com, Weekender: Park City Utah, Jan/Feb
- 2013 Castle Rock News Press, January 3rd, front page
- 2012 Castle Rock News Press, July 12th, Life, page 20
- 2012 Castle Rock News Press, June 28th, front page
- 2012 Castle Rock News Press, January 26th, Life, page 9A
- 2012 Castle Rock News Press, January 5th, front page
- 2010 The Taos News, August 4th, Tempo section, front page
- 2008 Ketchikan Daily News, July 26 -27th., front page
- 2008 Denver Post, May 7th., Denver & the West section B, cover
- 2008 Sculptural Pursuit, Summer 2008, page 103
- 2008 The Guild Sourcebook of Residential Art 6, page 258
- 2007 American Art Collector, February 2007, cover and page 125
- 2006 Cultural Times, November 2006, pages 12-13
- 2006 Mountain Connection, June 2006, cover, page 10
- 2005 Elevated Living, December 2005, page 38-39, Bunny Ears Publishing Corp.
- 2005 Log Home Design Ideas, January 2005, page 24, Active Interest Media Publication
- 2004 Log & Timber Style, August 2004, Artisan File; page 12, Wiesner Publishing
- 2004 Channel 4 News, May 26th, promoting the Colorado Artist Festival
- 2003 Art Review, Denver Post Style, and Channel 4 News, November, all promoting the Colorado Art Expo
- 2003 Castle Rock News Press, article on sculpture for the new library, August 21 and Sept. 25th, 2003
- 2002 *Better Homes & Gardens Paint It!*, Des Moines, Iowa; Page 154-155, Meredith Publishing Group

Education

- 1981 Florissant Valley Community College, St. Louis, Mo., Associates Degree in commercial art
- 2001 Penland School of Crafts, Asheville N.C., Surface Design on Wood workshop
- 2002 Anderson Ranch Art Center, Snowmass, CO, Carving and Shaping Wood workshop
- 2004 Anderson Ranch Art Center, Snowmass, CO, Color and Form with Wood workshop
- 2005 Anderson Ranch Art Center, Snowmass, CO, Building for the Outdoors Wood workshop

References

Mary Williams
7205 Middleham Place
Castle Rock, CO 80108
303-570-9435
www.MaryWilliamsArt.com
mwadart@comcast.net

Dana Betta Dalla
Aspen Ski Company
phone - (303) 664-530
email - ddallabetta@aspensnowmass.com
Project - Children's Center at Buttermilk Ski Resort

Skye Stekoll
CBJ Engineering Department
155 S. Seward St.
Juneau, AK 99801
(907) 586-0887
Email Skye.Stekoll@juneau.org
Projects: Eaglecrest Porcupine Lodge

Nancy Noyes
Noyes Art Design
phone - 303-332-8838
email - nnoyes@noyesartdesigns.com
Projects: Denver healthcare, corporate and residential commissions

Inventory List

Mary Williams/John King

1. Hibiscus Flower Sculpture 2017 11' x 12' x 12'

Located at the Castle Rock Adventist Hospital Healing Garden, Castle Rock, CO.

The donor requested the theme of a Hibiscus flower. The pedals of the flower were created in ground by using a graphic pattern of Lithocrete (crushed glass in bedded in concrete). The concrete stem with the kinetic component mimic the stamen of the flower. The kinetic component is intended to create a calming motion for mediation purposes within the garden. When approaching the sculpture from the garden level the pedals are revealed so that the viewer can discover the sculpture is a flower. The views from 2nd and 3rd floors of the surrounding buildings reveal the complete flower. The motion from the stamen invites the viewer to visit the garden for a closer look.

Medium: Lithocrete concrete, automotive paints on steel.

Mary Williams

2. Memorial Candles 2017 7' x 6' x 5'

Located at the Parker Adventist Hospital Healing Garden, Parker, CO.

The objective of these sculptures was to create a memorial for associates of the hospital who had passed. Candles are a beautiful and appropriate sign of the continued beauty and meaning of someone's life. Lighting a candle provides comfort, warmth and hope, and often helps with the grieving process. The kinetic flames flicker in the wind symbolizing eternal light.

Medium: steel and patina copper.

Mary Williams

3. Solstice Sculptures 2011 Summer 9' tall x 10' w x 10'd Winter 6'tall x 3'w x 3'd

Located at the Elk Ridge Park, Castle Pines, CO.

Mary's collaboration with the landscape architects, Design Concepts, was a successful example of a design team and artist working together to realize and create their vision of geology and discovery. The interaction of the summer and winter solstice within the sculptures created an ongoing opportunity for engagement with the community. For three weeks around the solstices the sun passes through the sculptures and marks another sculpture on the ground.

Medium: interior steel armature, epoxy clay, finished with a bronze, copper and aluminum metal cladding.

Mary Williams

4. Beaver Creek Totems 2005 14' tall x 12' w x 12"d

Located at Beaver Creek Ski Resort, Beaver Creek, CO.

Commissioned to create a totemic structure that would hold the kids ski school trail map. Images used were inspired from the trail run names. This sculpture has become an icon for the kids school and photographic point for many families.

Medium: Cedar, outdoor house paint, automotive urethane.

Mary Williams

5. BOB 2003 8' tall x 5'w x 5' d (suspended from a 30 ft. ceiling)

Located at Philip S Miller Library, Castle Rock, CO

This commission's objective was to create a colorful and whimsical sculpture to hang in a glass tower devoted to teens only. The space required the sculpture to hang from a 30' ceiling and speak to the teen audience. This objective was accomplished by the color, design, use of local aspen trees and neon. We had a contest for the teens to name the sculpture which created a sense of ownership and established a gathering place that was unique for them.

Medium: aspen, acrylic, aluminum, neon

John King

1. Cloud Castles 2016 18' high, 12'w x 12'd.

Located at Rotella Park, Adams County, CO.

One of three Interactive and wind activated sculptures. All on the theme of "Look Up". The piece is turned by the viewer engaging them to look up at the shapes intermingling with each other as if clouds were flying overhead.

Medium: Powder coated steel.

John King

2. Taking Wing 2016 2 towers, 20' tall x 10' w x 10'd.

Located at Denver Public Schools Emily Griffith Campus, Denver, CO.

Taking Wing references the life journeys of the students of the 5 schools located within the high rise building. Wind activated.

Medium: Powdercoated steel.

John King

3. Star Catcher 2017 14' tall x 10'w x 10'd.

Located at Children's Hospital, Denver, CO.

An engaging meditation on the sky... Turning the sculpture reflects ones' attention upward... helpful to visitors during times of challenge.

Medium: Automotive paints on steel.

John King

4. Lollipop Tree 2017 17' tall x 14' w x 14' d.

Located at Uptown Trees, Greeley, CO.

The Lollipop Tree was chosen as a commission for the Greeley Uptown Trees exhibit. Brightly colored leaves and lollipops turn and tumble in the breeze. The piece handles itself well in light and strong winds.

Medium: Automotive paints on steel.

John King

5. Sunrise 2017 20' tall x 18' w x 6'd.

Located at Aurora City Center Rail Station, Aurora, CO.

A large interactive turning sun with flashing elements is turned by passers by on the light rail train platform. Created to engage the travelers as they wait for the train.

Medium: Automotive paints on steel.











Castle Rock
Adventist Hospital
+ Centura Health





















